



# POSOW

Preparedness for Oil-polluted

Shoreline cleanup and

Oiled Wildlife interventions

## Facilities for Oiled Wildlife

- What is a facility?
- Functions of a facility
- Setting up a Beachhead Collection Point
- Setting up a Forward Holding Centre
- Building cages and pens



# Overview of the wildlife course

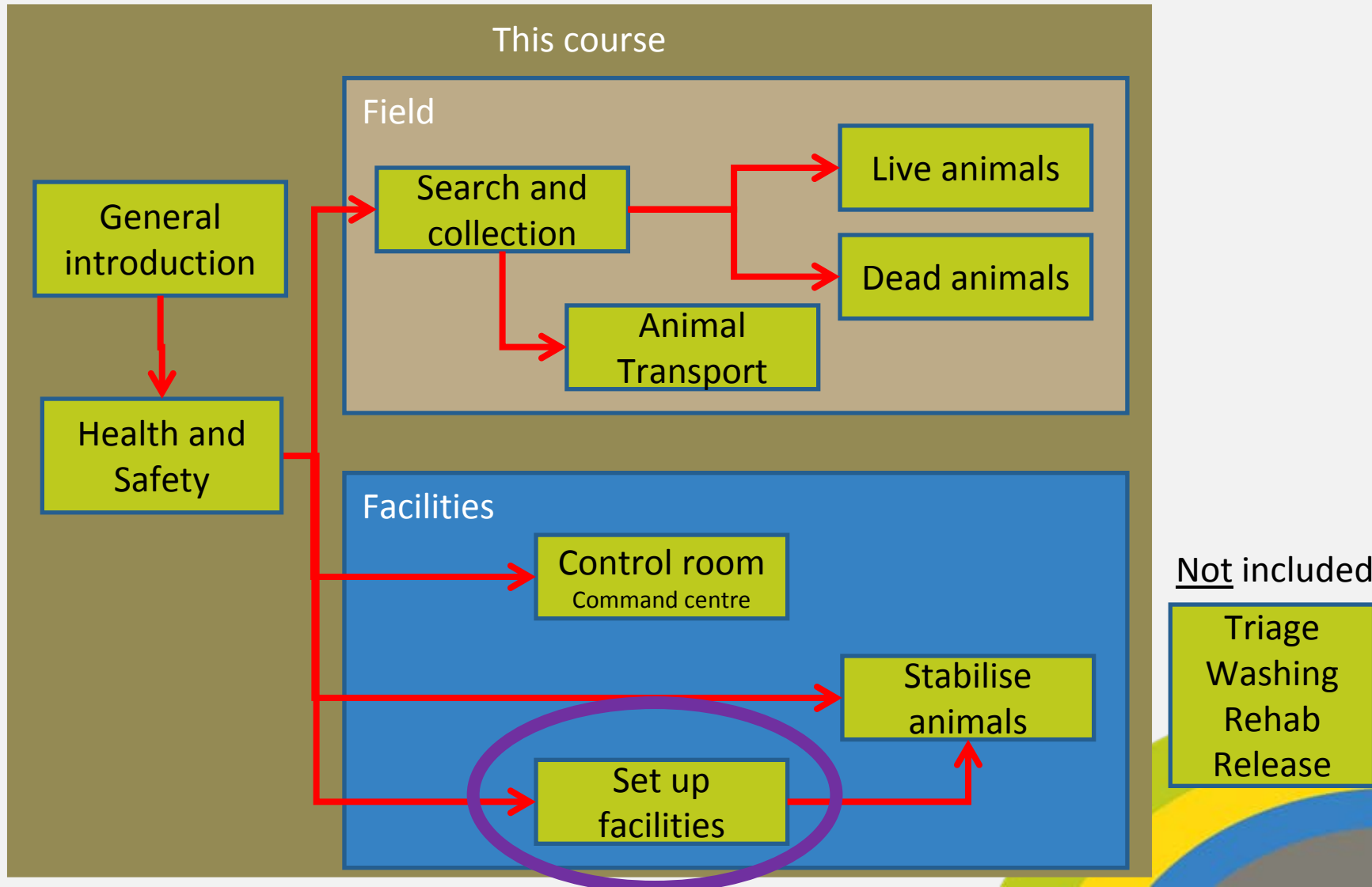

# What is a facility?



- Artificial environment to facilitate the optimal treatment of animals
- Shelter from elements
- Space, Electricity, Water
- Environmental control (temperature, humidity, ventilation-aircon)
- Facility has departments
- Inside departments: housing of animals



# What is a facility?



- Permanent wildlife centre
  - All systems functional



- Building of opportunity
  - Empty, available
  - Right location
  - To be transformed



- Tent setup
  - Flexibility
  - To be constructed



# Functions of a facility?



- Shelter
- Warmth (lamp)
- In boxes

- Beachhead Collection Point
  - Short stay of animals
    - not overnight



- Shelter
- Climatised
- Proper housing
- Triage
- Feeding

- Forward Holding Centre
  - Stabilisation
  - Keep alive
    - (for transport, washing)



- FHC+
- Wash room
- Pools
- Release programme

- Wildlife Rehab Centre
  - All rehabilitation functions



# Setup of Beachhead Collection Point (BCP)

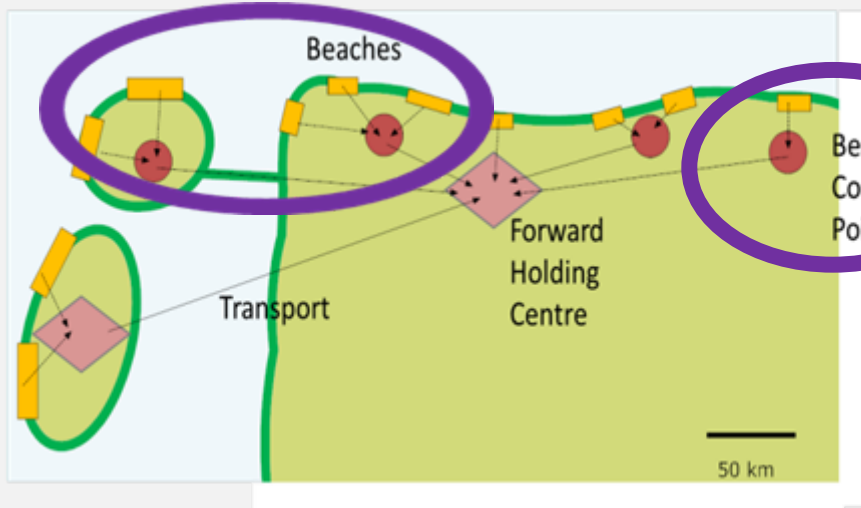

- Temporary accommodation for animals just captured
- Animals in boxes
- No animals at night
- Near to the beach
- Simple set-up
  - A vehicle (and/or tent)
  - A building with a ventilated and warm room

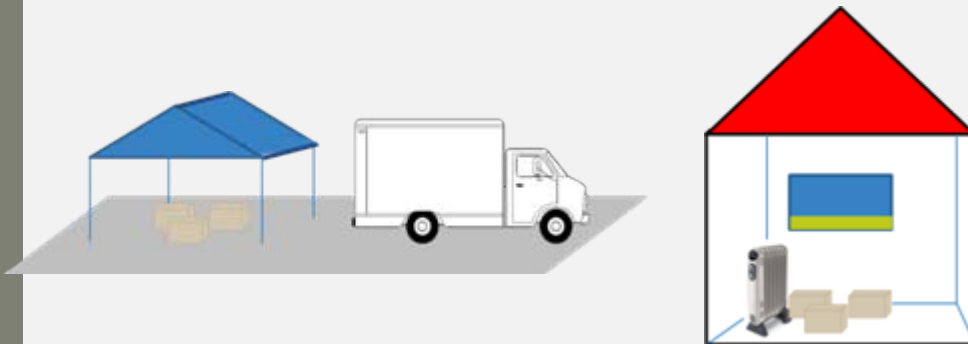



# Setup of a Forward Holding Centre(FHC)

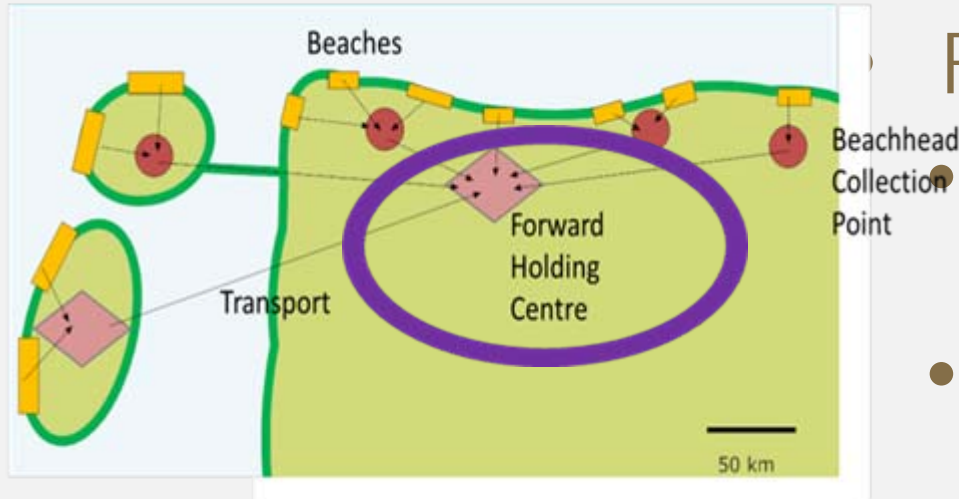

## Forward Holding Centre

- Receives all animals from field operations/ BCP`s
- Stabilises and keeps animals alive until Wildlife Rehabilitation Centre is available
- Animals stay at night

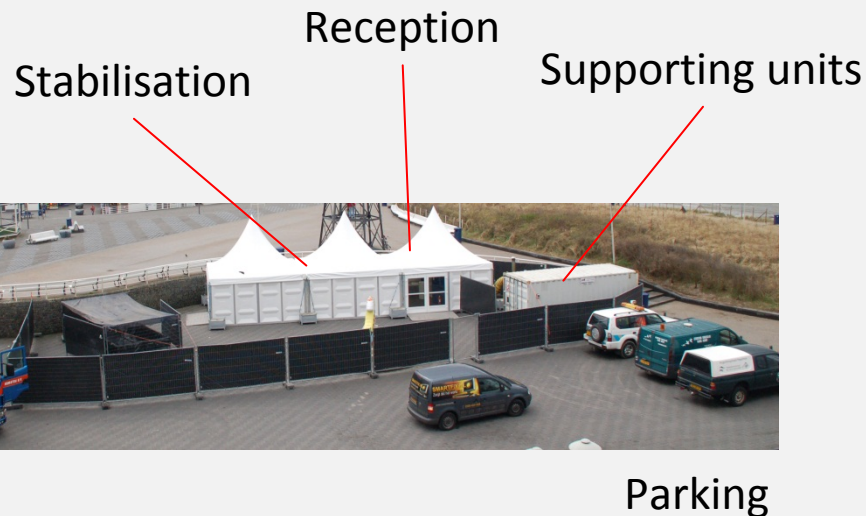

# Setup of a Forward Holding Centre

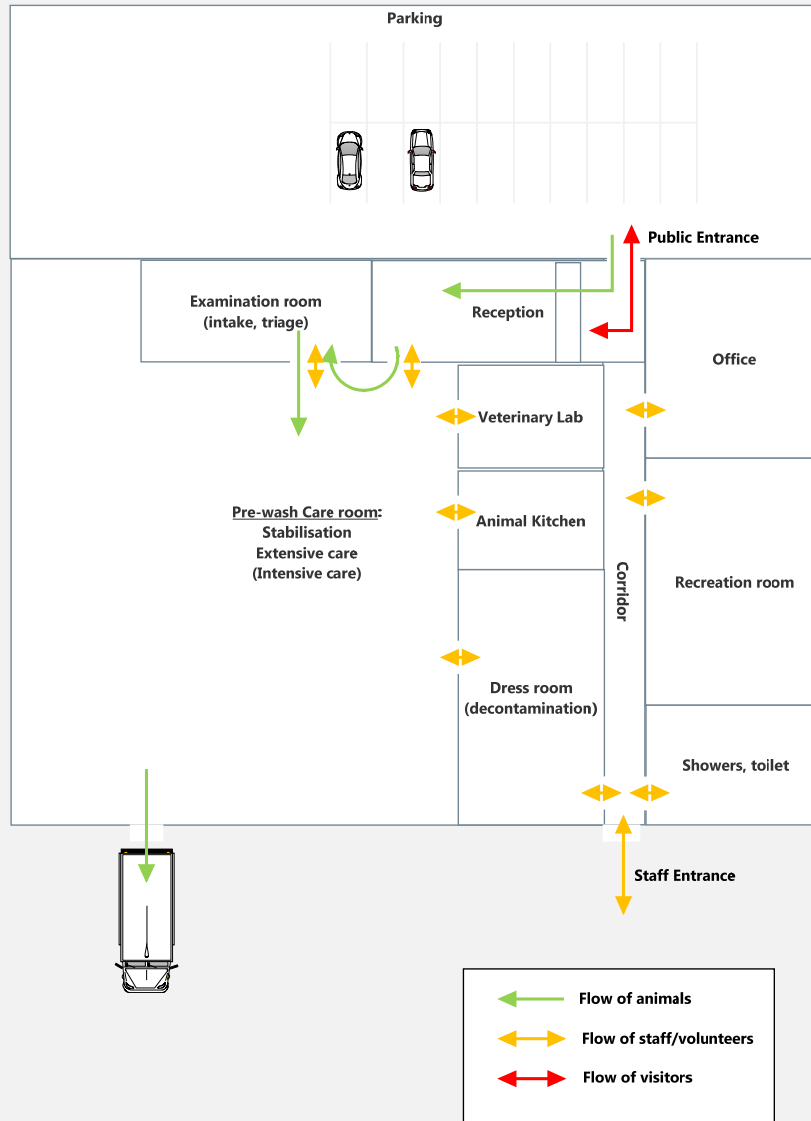

## Zoning

- Flow of visitors
  - To desk of reception
- Flow of staff
  - Clean areas
  - Dirty areas
    - Via decontamination
- Flow of animals
  - One direction
  - (no crossing)



# Animal housing – dirty area

- Environment
  - Warm (18-20°C)
  - Natural light
  - Some artificial light
- Hygiene
  - Washable floors & walls
  - Well ventilated
  - Quiet area



# Housing the animals - caging



# Housing the animals – caging detail

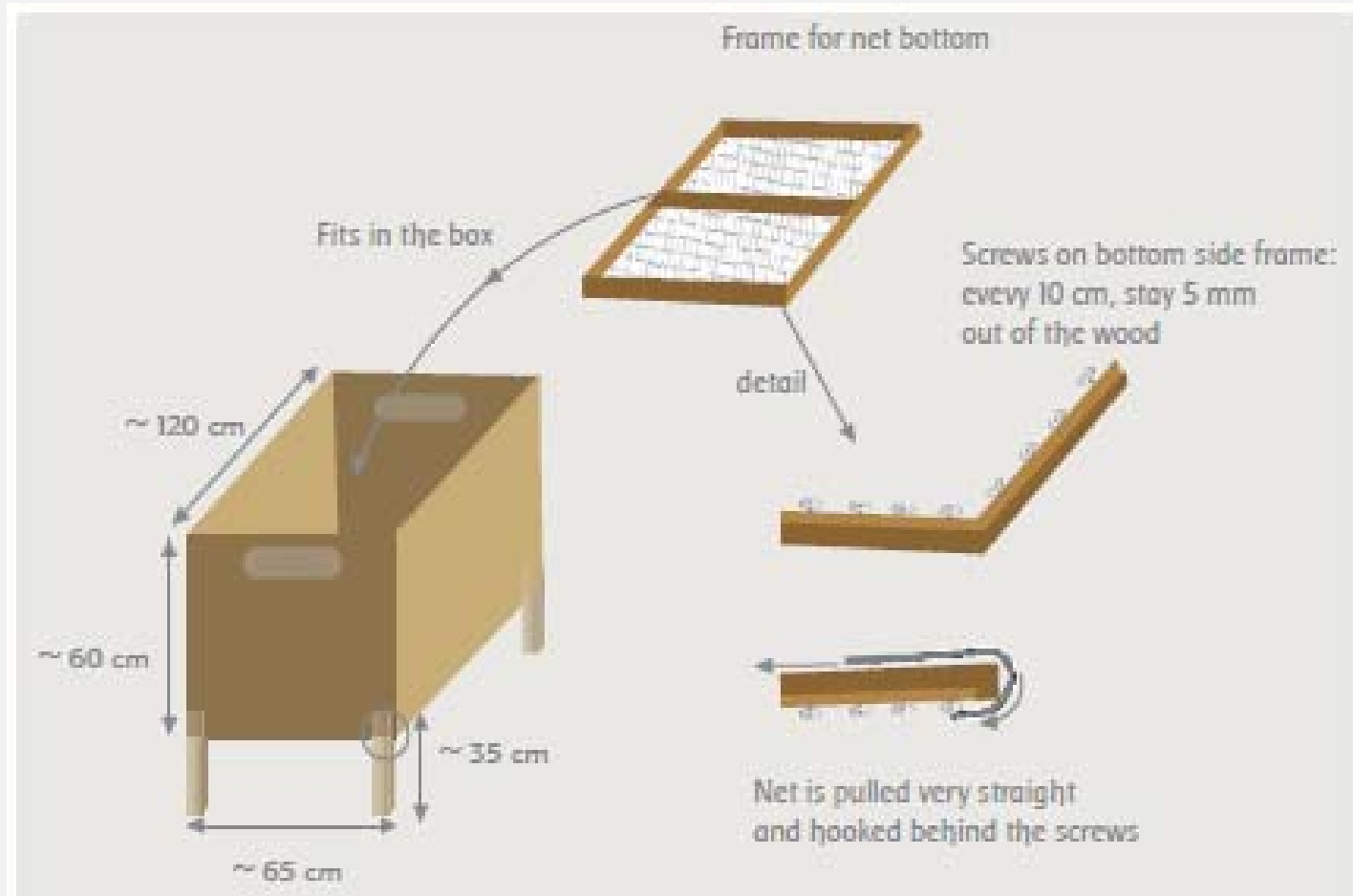



# Animal housing - alternatives



- Net-bottomed cages may not be immediately available
- They are also not suitable for waders or swans



Alternatives include:

- Dry, clean wood shavings
- Layers of towels
- **NO** hay or straw
- **NOT** in direct contact with hard surfaces

# Animal kitchen



- Various preparations
  - Rehydration fluids
  - Fish/pellets/...
- Ergonomics



# POSOW Manual

3

## Setup and layout of a forward holding centre

Flow of animals: →  
 Flow of staff/resources: →  
 Flow of stores: →

<b>Reception</b> Desk Space to put bird boxes White board <b>Examination room (if vet available)</b> Water, electricity Table Cupboard with medical equipment, medicine Scales <b>Stabilisation room</b> Clean working environment Good ventilation Net bottom cages and pens <b>Dressing room</b> Benches and hooks Lockers for personal belongings Sign with instructions	<b>Corridor</b> Connecting all indicated rooms Signposts <b>Office/Command Centre</b> Refer to datasheet n°11 Veterinary lab (if vet available) <b>Animal kitchen</b> Hot/cold water Work tables Fridge, freezer Microwave, mixers	<b>Showers/toilet</b> For women For men Hot/cold running water Benches/chairs Coat hook <b>Reception room</b> Tables, chairs White board Mugs, plates, cutlery Fridge with snacks Microwave <b>Parking</b> Parking space Security checkpoint Signposted Waste storage containers <b>Stability as a window</b> Existing building or party tents Hot & cold water, electricity Climate control (ventilation) Space & flexibility Near city/ main roads
---	--	--

Checklist of most important characteristics and equipment

38

## Animal housing

Building schedule for a net bottom cage –  
 basic materials:  
 → 16 mm plywood, square timber, minimum 4 cm x 4 cm  
 → nylon fishing net without knots, 10 mm mesh

→ screws: long ones for construction, short ones for tightening the net

Frame for net bottom  
 Fits in the box  
 Screws on bottom side of frame every 10 cm, protruding 5 mm out of the wood  
 Net is pulled very tight and hooked behind the screws

Net bottom cage

49



Thank you very much!

Questions?

Des questions?

ερωτήσεις?

Otázky?

Domande?

Preguntas?

Mistoqsijiet?

Vprašanja?







# POSOW

Preparedness for Oil-polluted

Shoreline cleanup and

Oiled Wildlife interventions

## Disclaimer

All material produced under POSOW is available free of charge. No part of this PowerPoint presentation shall, by way of trade or otherwise, be lent, sold, hired or circulated for commercial purposes. The information available on this presentation is aimed only at facilitating access to information in the field of preparedness for and response to pollution from ships in the Mediterranean Sea. POSOW Presentations are made available for information purposes only. Any amendment, review, and update of the material produced under the project shall be authorized by REMPEC with the consent of its Partners and shall refer to the original document developed under the project. REMPEC and its partners do not assert that this material is faultless and make no warranty, nor assume any legal liability for the accuracy, completeness or usefulness of the information contained in the Presentation. REMPEC and its partners do not assume responsibility or liability for any direct, indirect or consequential damages from the use of the material available on the PowerPoint presentations of the Project POSOW.

### Legal information

REMPEC: Regional Marine Pollution Emergency Response Centre for the Mediterranean Sea

REMPEC

Maritime House, Lascaris Wharf

Valetta, VLT 1921, Malta

Tel: +356 21 337 296/7/8

Fax: +356 21 339 951

Email : [rempec@rempec.org](mailto:rempec@rempec.org)

Editor: F. HEBERT

